

ESCALA 1:25

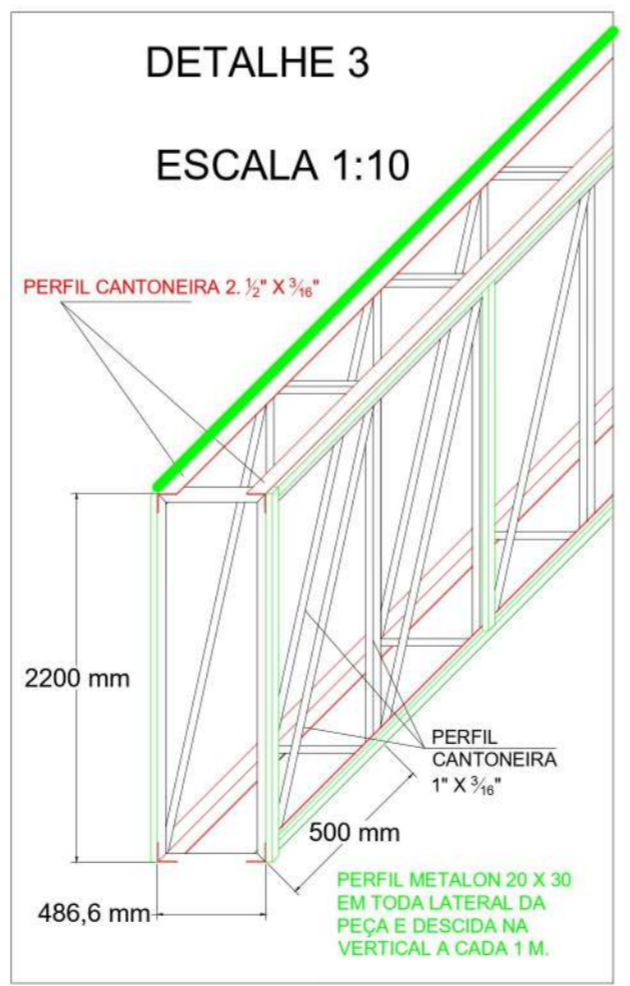
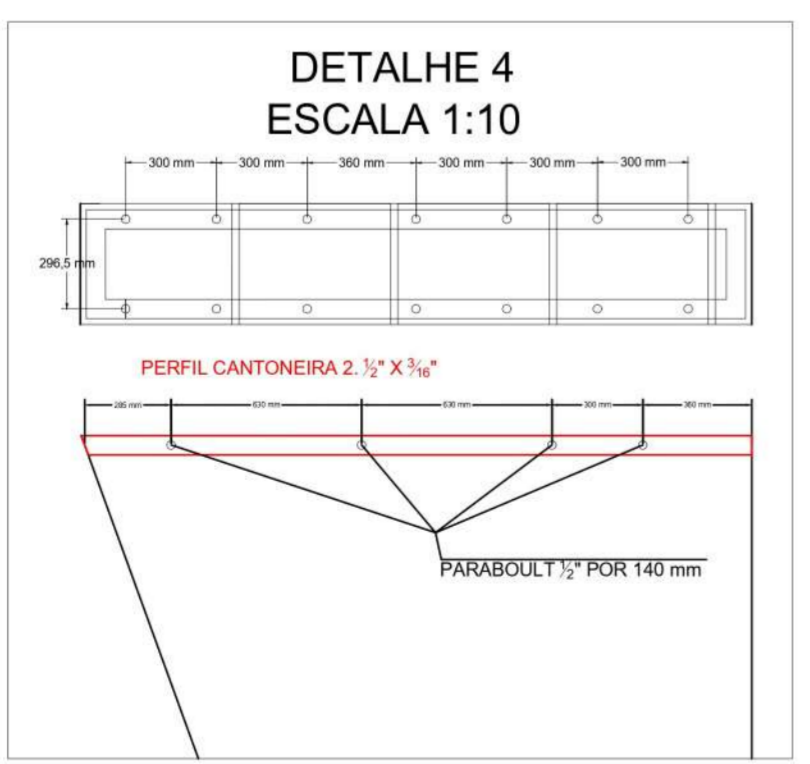
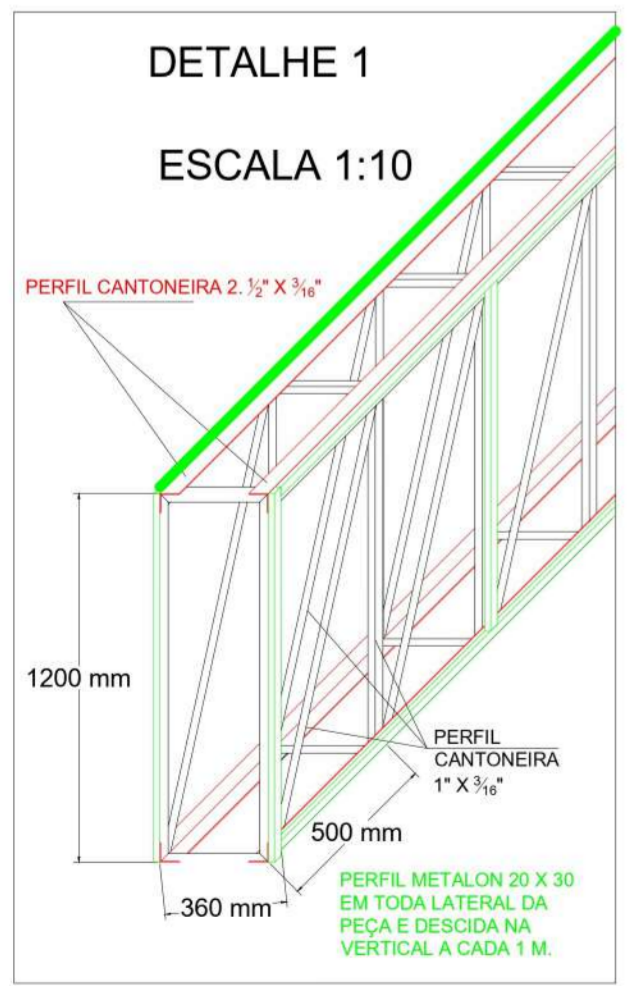
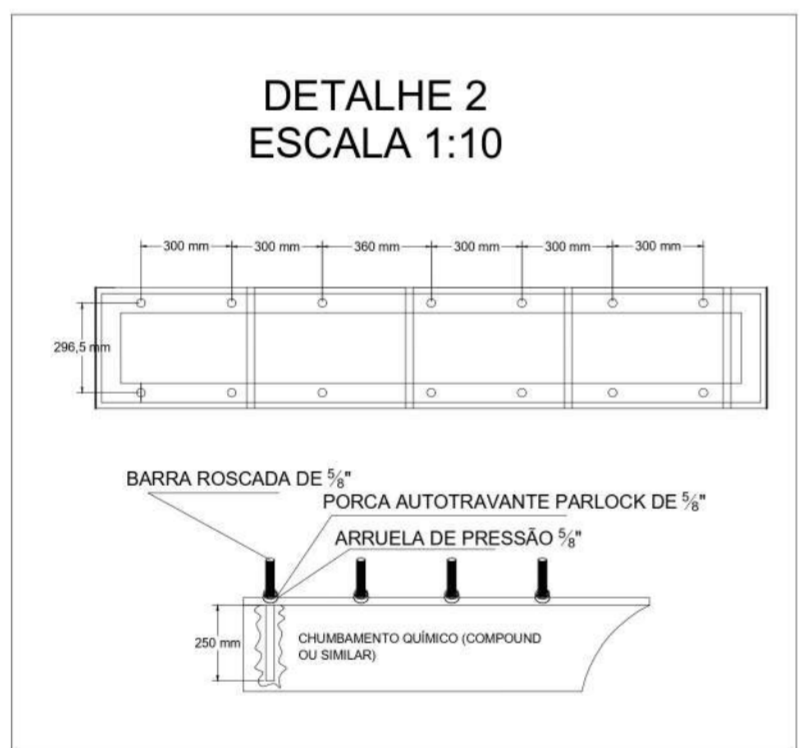

**PROJETO ESTRUTURAL**

**OBRA: Reforma e Adequação do Portal de Entrada da Cidade**

**LOCAL: Avenida Orestes Quércia - Pedregulho - SP**

*Elso Lemes Filho*

**ELSO LEMES FILHO**  
ENG. CIVIL - CREA 0601113022